

# OP 85L

01	FIXING BRACKET	2
02	CLAMP	2
03	FLAT WASHERS $\varnothing 8$ UNI 6592	6
04	STOP WASHERS $\varnothing 8$ UNI 6798	6
05	NUTS M8 UNI 5588	4
06	PIVOT BRACKET	1
07	REFLECTOR SUPPORT	1
08	BOLTS M8x120 UNI 5737	2
09	PIVOT PLATE	1
10	FEED ARM	1
11	BOLT M6x65 UNI 5739	2
12	FLAT WASHER $\varnothing 6$ UNI 6592	2
13	LOCK-NUTS M6 UNI 7474	4
14	REFLECTOR	1
15	BOLTS M6x12 UNI 5931	4
16	LNB HOLDER	1
17	SCREW DIN 6901	1
18	WING NUT ZING PLATED	2
19	M6 NUT UNI 5588	2

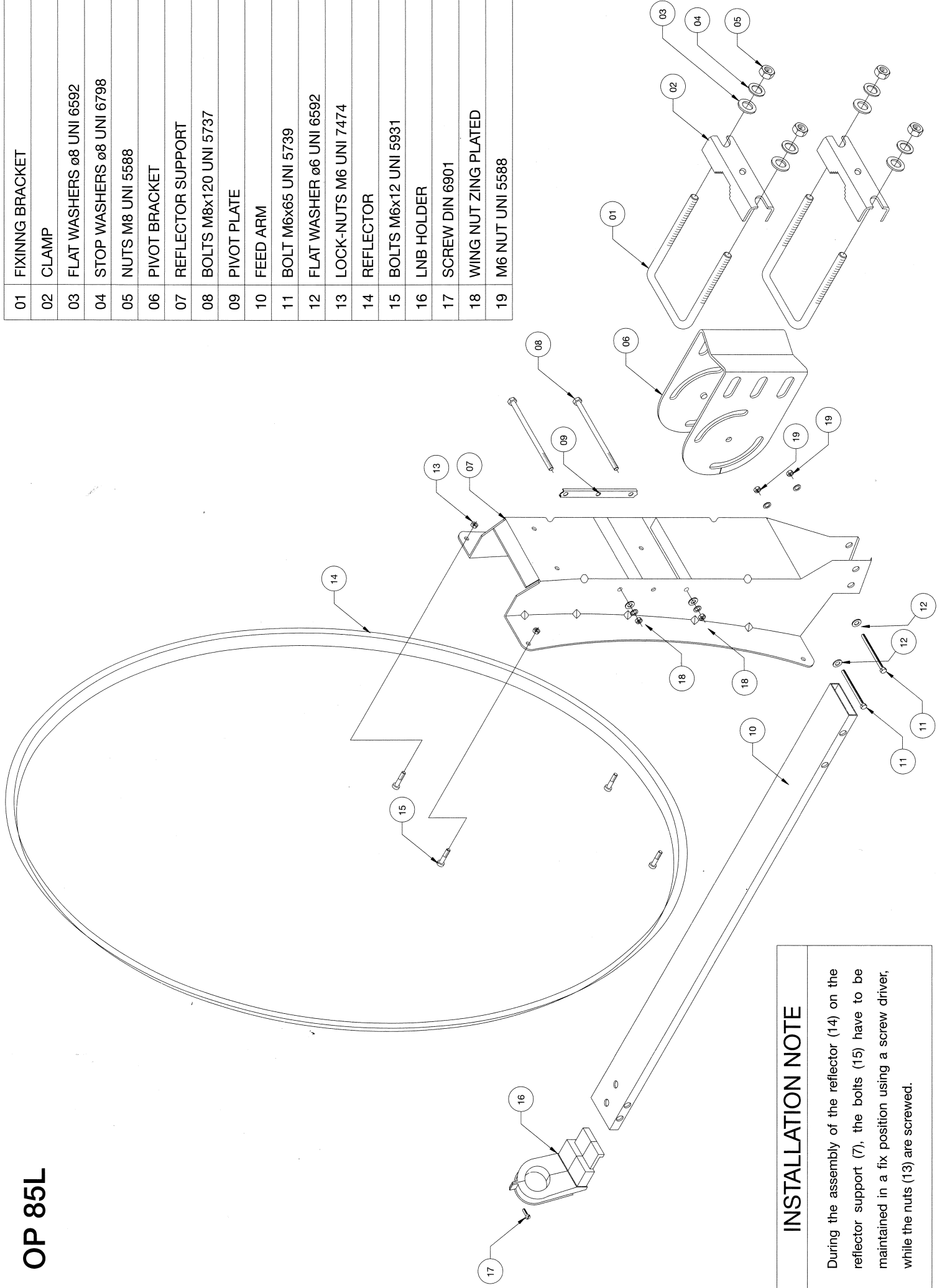

## INSTALLATION NOTE

During the assembly of the reflector (14) on the reflector support (7), the bolts (15) have to be maintained in a fix position using a screw driver, while the nuts (13) are screwed.