

01	FIXING BRACKET	2
02	CLAMP	2
03	FLAT WASHERS Ø8 UNI 6592	6
04	STOP WASHERS Ø8 UNI 6798	6
05	NUTS M8 UNI 5588	6
06	PIVOT BRACKET	1
07	REFLECTOR SUPPORT	1
08	BOLTS M8x120 uni 5737	2
09	PIVOT PLATE	1
10	FEED ARM	1
11	BOLT M6x65 UNI 5739	1
12	FLAT WASHER Ø6 UNI 6592	2
13	NUTS M6 UNI 7473	5
14	REFLECTOR	1
15	BOLTS M6x12 UNI 5931	4
16	LNB HOLDER	1
17	SCREW DIN 6901	1

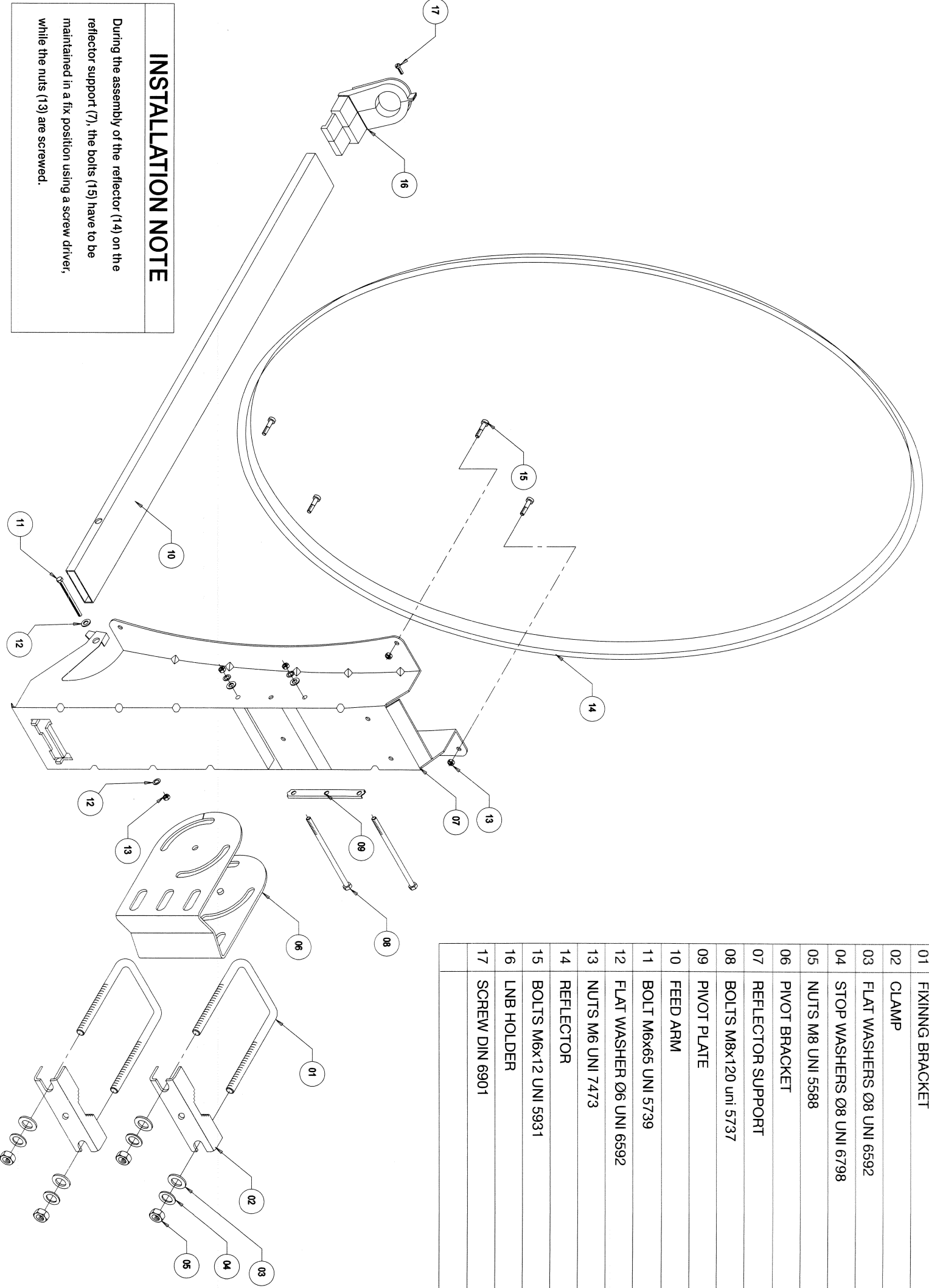

## INSTALLATION NOTE

During the assembly of the reflector (14) on the reflector support (7), the bolts (15) have to be maintained in a fix position using a screw driver, while the nuts (13) are screwed.

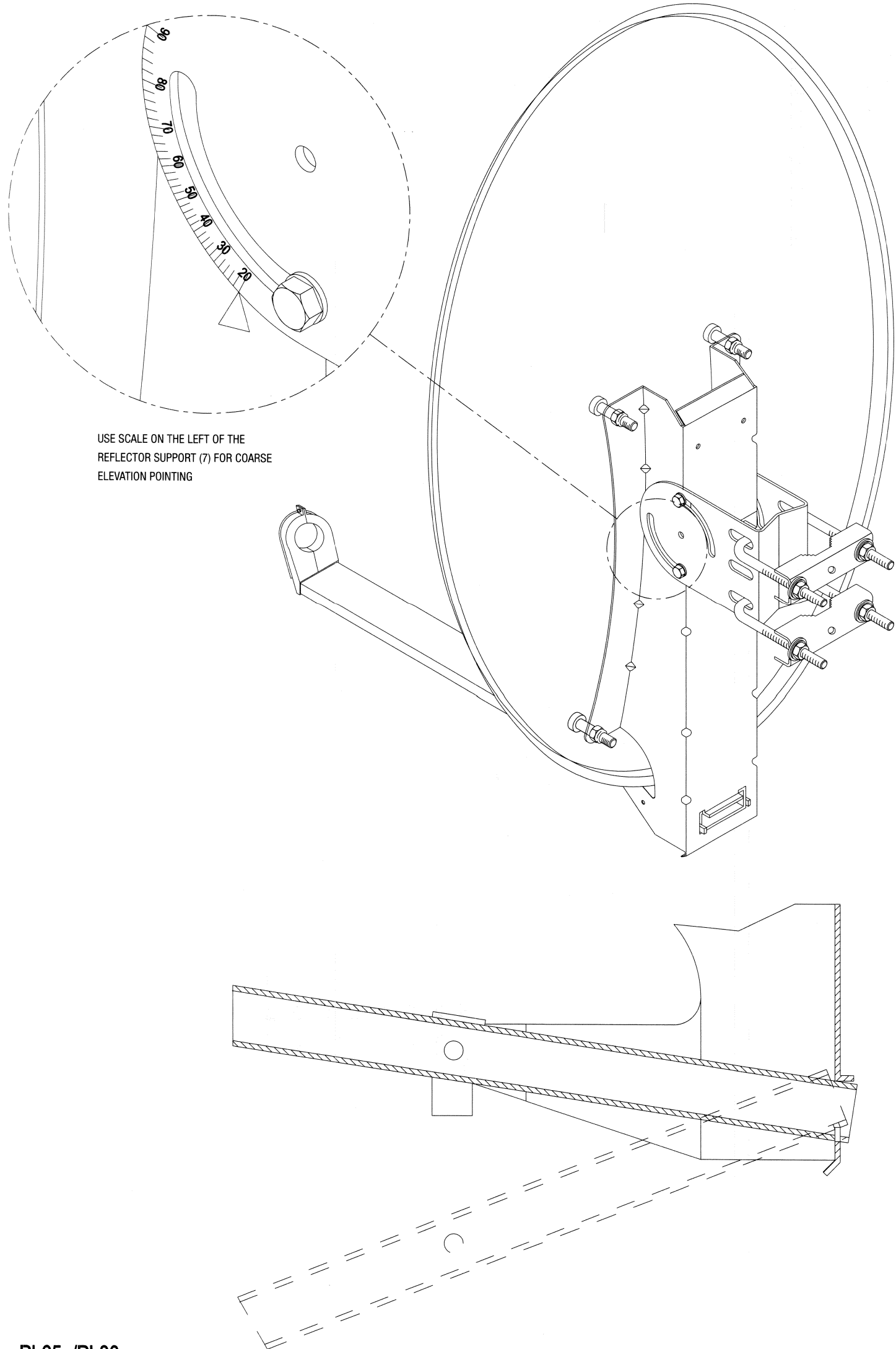

USE SCALE ON THE LEFT OF THE REFLECTOR SUPPORT (7) FOR COARSE ELEVATION POINTING

The image contains three technical drawings. The top-left drawing is a circular scale with a dashed outer boundary and a solid inner boundary. The scale is marked with numbers from 20 to 90 in increments of 10, with a small tick mark between each number. A curved line is drawn across the scale, and a hexagonal nut is shown at the bottom right of the scale. A dashed line connects the center of the scale to the main assembly drawing. The main assembly drawing is a perspective view of a large, oval-shaped reflector dish. A vertical support structure is attached to the back of the dish. This structure has several horizontal bars and bolts. A circular scale is mounted on the support structure, and a dashed line indicates its position relative to the main drawing. The bottom drawing is a cross-sectional view of the support structure, showing a long, thin horizontal bar with a circular hole in the center. The bar is supported by a vertical post. The bar is attached to a larger vertical structure on the right. Dashed lines indicate the hidden parts of the structure.