



User Manual

dSCR Programmer

Ref. 9729



TABLE OF CONTENTS

1. HOW TO USE THE DSCR PROGRAMMER	3
2. CONFIGURATION FILE FOR DYNAMIC DIGITAL LNB	4
3. CONFIGURATION FILE FOR STATIC DIGITAL LNB	5
4. SAFETY INSTRUCTIONS	6
5. CONDITIONS OF WARRANTY.....	7

No part of this manual may be copied, reproduced, transmitted, transcribed or translated into any language without permission.

Unitron reserves the right to change the specifications of the hardware and software described in these manuals at any time.

Unitron cannot be held liable for any damages resulting from the use of this product. Specifications are subject to change without notice. 3/18

© Unitron - Frankrijklaan 27 - B-8970 Poperinge - Belgium

T +32 57 33 33 63 **F** +32 57 33 45 24

email sales@unitrongroup.com

www.unitrongroup.com

1. HOW TO USE THE DSCR PROGRAMMER

Configuration file

1. Login to <https://remote.uui-platform.com> (if necessary, register a new account)
2. On the dashboard, select the product you wish to manage, e.g. the digital LNB.
3. To make a configuration file for the dSCR device, there are 3 options:
 - *Predefined configurations*: select a predefined configuration for the device
 - *New configuration*: make your own configuration
 - *Edit configuration*: edit an existing configuration file
4. Complete the online form for the configuration file based on your project needs.
5. Download and save the configuration file on a SD card. Make sure only one configuration file is stored on the SD card.

Configuring dSCR products

1. Power the dSCR Programmer with **18 Vdc minimum**. You can use a powersupply with a DC jack or an F-connector.
2. Insert the SD-card in the dSCR Programmer. When the dSCR Programmer detects the configuration file, this is indicated with a solid **GREEN** LED. A blinking **RED** LED indicates no SD card or no valid configuration file.
3. Connect the dSCR device (LNB, Multiswitch,...) to the dSCR Programmer using the program port. Wait a few seconds to let the dSCR device fully boot (5 sec. approx.).
4. Tap the button on the dSCR Programmer for 2 seconds to start the configuration. The status LED will blink **ORANGE** until configuration is finished. This can take a few minutes. A successful configuration is indicated with a solid **GREEN** status LED. If the status LED is solid **ORANGE** or there is no LED at all, the configuration did not succeed. If the status LED is solid **RED**, the configuration file is not correct. In that case, check the configuration file and retry the configuration.
5. To repeat the configuration, connect the dSCR Programmer to other dSCR devices.

System diagram

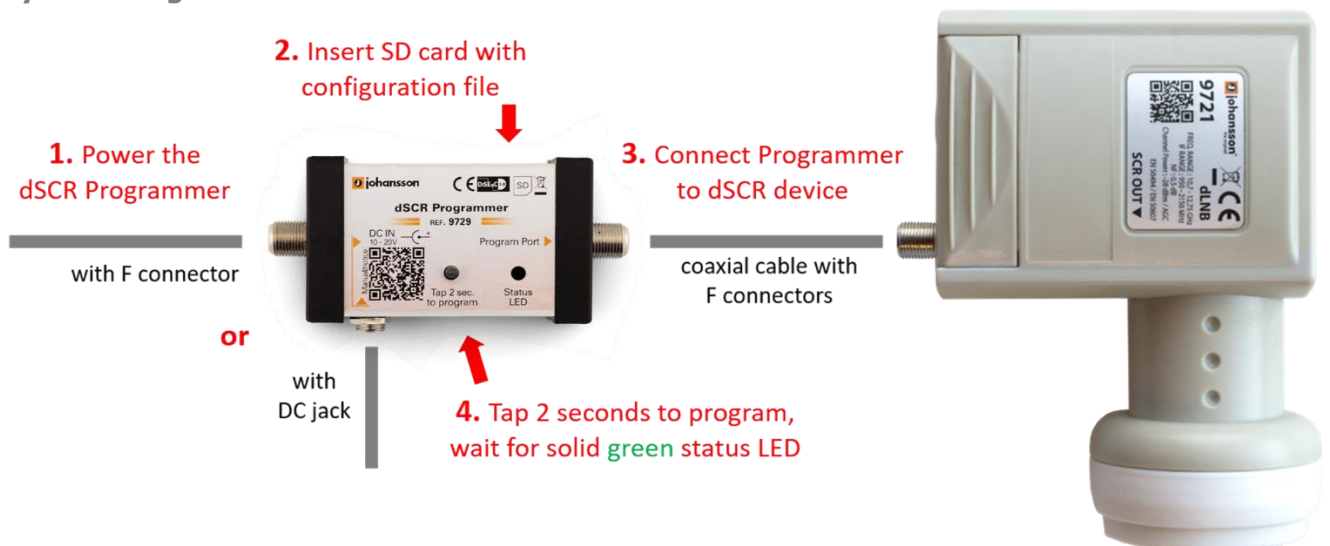

2. CONFIGURATION FILE FOR DYNAMIC DIGITAL LNB

An example of a configuration file for a **dynamic** digital LNB can be found on the online platform. Go to Predefined configurations and load dSCR-UNI. Click Download and save the file to the SD card.

The screenshot shows the configuration interface for a digital LNB. At the top, there is a navigation bar with 'uCloud', 'LNB', 'Home', 'Predefined configurations', 'New configuration', and 'Edit configuration'. Below this, a dropdown menu shows 'dSCR-UNI' and a 'Load' button. The main title is 'dSCR-UNI'. A horizontal line separates the title from the 'CONFIGURATION PARAMETERS' section. Under this section, there are radio buttons for 'Static' and 'Dynamic', with 'Dynamic' selected. Below the radio buttons are input fields for 'LOW band LO' (9750) and 'HIGH band LO' (10600). Further down is an input field for 'Number of bands' (16). The main part of the interface is a table with 5 columns: 'UB frequency', 'UB bandwidth', 'UB RF power', 'Supported protocols', and 'UB ID'. Each row represents a band configuration. The 'Supported protocols' column has a dropdown menu for each row, with 'Both' selected for bands 1-4 and 'EN50607' selected for bands 5-16. At the bottom of the table is a 'Download' button.

UB frequency	UB bandwidth	UB RF power	Supported protocols	UB ID
1210	50	-25	Both	1
1420	50	-25	Both	2
1680	50	-25	Both	3
2040	50	-25	Both	4
985	50	-25	EN50607	5
1050	50	-25	EN50607	6
1115	50	-25	EN50607	7
1275	50	-25	EN50607	8
1340	50	-25	EN50607	9
1485	50	-25	EN50607	10
1550	50	-25	EN50607	11
1615	50	-25	EN50607	12
1745	50	-25	EN50607	13
1810	50	-25	EN50607	14
1875	50	-25	EN50607	15
1940	50	-25	EN50607	16

3. CONFIGURATION FILE FOR STATIC DIGITAL LNB

An example of a configuration file for a **static** digital LNB can be found on the online platform. Go to Predefined configurations and load UNI-STATIC. Click Download and save the file to the SD card.

uCloud
LNB
Home
★ Predefined configurations
+ New configuration
Edit configuration

UNI-STATIC ▾
Load

UNI-STATIC

CONFIGURATION PARAMETERS

Static Dynamic

Number of bands :

Polarity	Input frequency	UB frequency	UB bandwidth	UB RF power
<input type="radio"/> H <input checked="" type="radio"/> V	<input type="text" value="10700"/>	<input type="text" value="950"/>	<input type="text" value="30"/>	<input type="text" value="-25"/>
<input type="radio"/> H <input checked="" type="radio"/> V	<input type="text" value="10735"/>	<input type="text" value="985"/>	<input type="text" value="30"/>	<input type="text" value="-25"/>
<input type="radio"/> H <input checked="" type="radio"/> V	<input type="text" value="10770"/>	<input type="text" value="1020"/>	<input type="text" value="30"/>	<input type="text" value="-25"/>
<input type="radio"/> H <input checked="" type="radio"/> V	<input type="text" value="10805"/>	<input type="text" value="1055"/>	<input type="text" value="30"/>	<input type="text" value="-25"/>
<input type="radio"/> H <input checked="" type="radio"/> V	<input type="text" value="10840"/>	<input type="text" value="1090"/>	<input type="text" value="30"/>	<input type="text" value="-25"/>
<input type="radio"/> H <input checked="" type="radio"/> V	<input type="text" value="10875"/>	<input type="text" value="1125"/>	<input type="text" value="30"/>	<input type="text" value="-25"/>
<input type="radio"/> H <input checked="" type="radio"/> V	<input type="text" value="10910"/>	<input type="text" value="1160"/>	<input type="text" value="30"/>	<input type="text" value="-25"/>
<input type="radio"/> H <input checked="" type="radio"/> V	<input type="text" value="10945"/>	<input type="text" value="1195"/>	<input type="text" value="30"/>	<input type="text" value="-25"/>
<input type="radio"/> H <input checked="" type="radio"/> V	<input type="text" value="10980"/>	<input type="text" value="1230"/>	<input type="text" value="30"/>	<input type="text" value="-25"/>
<input type="radio"/> H <input checked="" type="radio"/> V	<input type="text" value="11015"/>	<input type="text" value="1265"/>	<input type="text" value="30"/>	<input type="text" value="-25"/>
<input type="radio"/> H <input checked="" type="radio"/> V	<input type="text" value="11050"/>	<input type="text" value="1300"/>	<input type="text" value="30"/>	<input type="text" value="-25"/>
<input type="radio"/> H <input checked="" type="radio"/> V	<input type="text" value="11085"/>	<input type="text" value="1335"/>	<input type="text" value="30"/>	<input type="text" value="-25"/>
<input type="radio"/> H <input checked="" type="radio"/> V	<input type="text" value="11120"/>	<input type="text" value="1370"/>	<input type="text" value="30"/>	<input type="text" value="-25"/>
<input type="radio"/> H <input checked="" type="radio"/> V	<input type="text" value="11155"/>	<input type="text" value="1405"/>	<input type="text" value="30"/>	<input type="text" value="-25"/>
<input type="radio"/> H <input checked="" type="radio"/> V	<input type="text" value="11190"/>	<input type="text" value="1440"/>	<input type="text" value="30"/>	<input type="text" value="-25"/>
<input type="radio"/> H <input checked="" type="radio"/> V	<input type="text" value="11225"/>	<input type="text" value="1475"/>	<input type="text" value="30"/>	<input type="text" value="-25"/>
<input type="radio"/> H <input checked="" type="radio"/> V	<input type="text" value="11260"/>	<input type="text" value="1510"/>	<input type="text" value="30"/>	<input type="text" value="-25"/>
<input type="radio"/> H <input checked="" type="radio"/> V	<input type="text" value="11295"/>	<input type="text" value="1545"/>	<input type="text" value="30"/>	<input type="text" value="-25"/>
<input type="radio"/> H <input checked="" type="radio"/> V	<input type="text" value="11330"/>	<input type="text" value="1580"/>	<input type="text" value="30"/>	<input type="text" value="-25"/>
<input type="radio"/> H <input checked="" type="radio"/> V	<input type="text" value="11365"/>	<input type="text" value="1615"/>	<input type="text" value="30"/>	<input type="text" value="-25"/>
<input type="radio"/> H <input checked="" type="radio"/> V	<input type="text" value="11400"/>	<input type="text" value="1650"/>	<input type="text" value="30"/>	<input type="text" value="-25"/>
<input type="radio"/> H <input checked="" type="radio"/> V	<input type="text" value="11435"/>	<input type="text" value="1685"/>	<input type="text" value="30"/>	<input type="text" value="-25"/>
<input type="radio"/> H <input checked="" type="radio"/> V	<input type="text" value="11470"/>	<input type="text" value="1720"/>	<input type="text" value="30"/>	<input type="text" value="-25"/>
<input type="radio"/> H <input checked="" type="radio"/> V	<input type="text" value="11505"/>	<input type="text" value="1755"/>	<input type="text" value="30"/>	<input type="text" value="-25"/>
<input type="radio"/> H <input checked="" type="radio"/> V	<input type="text" value="11540"/>	<input type="text" value="1790"/>	<input type="text" value="30"/>	<input type="text" value="-25"/>
<input type="radio"/> H <input checked="" type="radio"/> V	<input type="text" value="11575"/>	<input type="text" value="1825"/>	<input type="text" value="30"/>	<input type="text" value="-25"/>
<input type="radio"/> H <input checked="" type="radio"/> V	<input type="text" value="11610"/>	<input type="text" value="1860"/>	<input type="text" value="30"/>	<input type="text" value="-25"/>
<input type="radio"/> H <input checked="" type="radio"/> V	<input type="text" value="11645"/>	<input type="text" value="1895"/>	<input type="text" value="30"/>	<input type="text" value="-25"/>
<input type="radio"/> H <input checked="" type="radio"/> V	<input type="text" value="11680"/>	<input type="text" value="1930"/>	<input type="text" value="30"/>	<input type="text" value="-25"/>
<input type="radio"/> H <input checked="" type="radio"/> V	<input type="text" value="11715"/>	<input type="text" value="1965"/>	<input type="text" value="30"/>	<input type="text" value="-25"/>
<input type="radio"/> H <input checked="" type="radio"/> V	<input type="text" value="11750"/>	<input type="text" value="2000"/>	<input type="text" value="30"/>	<input type="text" value="-25"/>
<input type="radio"/> H <input checked="" type="radio"/> V	<input type="text" value="11785"/>	<input type="text" value="2035"/>	<input type="text" value="30"/>	<input type="text" value="-25"/>

Download

4. SAFETY INSTRUCTIONS



Read these instructions carefully before connecting the unit



To prevent fire, short circuit or shock hazard:

- Do not expose the unit to rain or moisture.
- Install the unit in a dry location without infiltration or condensation of water.
- Do not expose it to dripping or splashing.
- Do not place objects filled with liquids, such as vases, on the apparatus.
- If any liquid should accidentally fall into the cabinet, disconnect the power plug.



To avoid any risk of overheating:

- Install the unit in a well aery location and keep a minimum distance of 15 cm around the apparatus for sufficient ventilation
- Do not place any items such as newspapers, table-cloths, curtains, on the unit that might cover the ventilation holes.
- Do not place any naked flame sources, such as lighted candles, on the apparatus
- Do not install the product in a dusty place
- Use the apparatus only in moderate climates (not in tropical climates)
- Respect the minimum and maximum temperature specifications



To avoid any risk of electrical shocks:

- Connect apparatus only to socket with protective earth connection.
- The mains plug shall remain readily operable
- Pull out power plug to make the different connections of cables
- To avoid electrical shock, do not open the housing of adapter.



Maintenance



Only use a dry soft cloth to clean the cabinet.



Do not use solvent



For repairing and servicing refer to qualified personnel.



Dispose according your local authority's recycling processes

5. CONDITIONS OF WARRANTY

Unitron N.V. warrants the product as being free from defects in material and workmanship for a period of 24 months starting from the date of production indicated on it. See note below.

If during this period of warranty the product proves defective, under normal use, due to defective materials or workmanship, Unitron N.V, at its sole option, will repair or replace the product. Return the product to your local dealer for reparation

THE WARRANTY IS APPLIED ONLY FOR DEFECTS IN MATERIAL AND WORKMANSHIP AND DOES NOT COVER DAMAGE RESULTING FROM:

- Misuse or use of the product out of its specifications.
- Installation or use in a manner inconsistent with the technical or safety standards in force in the country where the product is used
- Use of non-suitable accessories (power supply, adapters...).
- Installation in a defect system.
- External cause beyond the control of Unitron N.V. such as drop, accidents, lightning, water, fire, improper ventilation...

THE WARRANTY IS NOT APPLIED IF

- Production date or serial number on the product is illegible, altered, deleted or removed.
- The product has been opened or repaired by a non-authorized person.

NOTE

Date of production can be found in the product's serial number code. The format will either be "YEAR W WEEK" (e.g., 2016W01 = year 2016 week 1) or "YYWW" (e.g., 1447 = year 2014 week 47).



www.unitrongroup.com

UNITRON NV
Frankrijklaan 27
B-8970 Poperinge
Belgium

T +32 57 33 33 63
F +32 57 33 45 24

sales@unitrongroup.com
www.unitrongroup.com